

# LEFT RAIL SLIDER

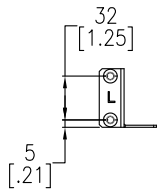

FRONT VIEW

# RIGHT RAIL SLIDER

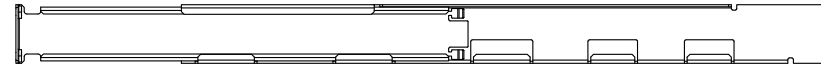
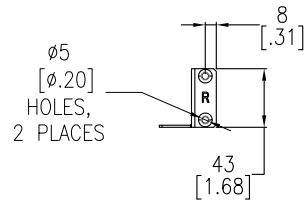

SIDE VIEW

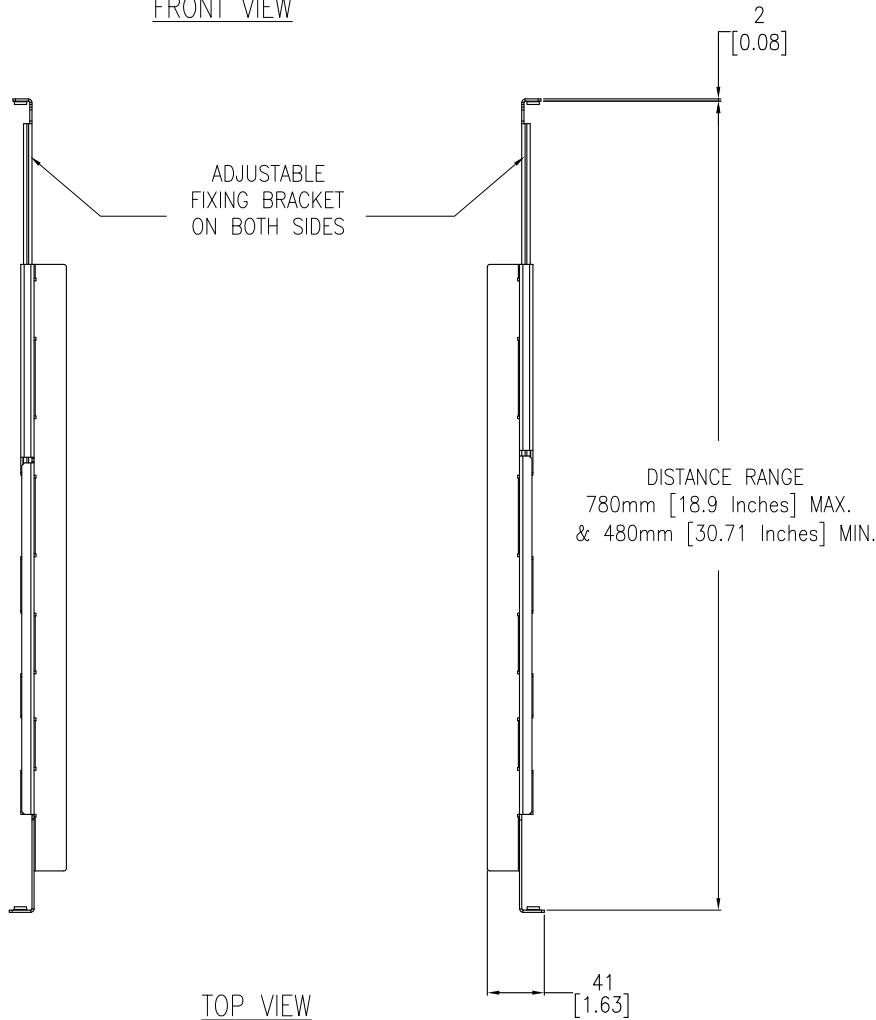

TOP VIEW

## PACKAGE CONTENTS

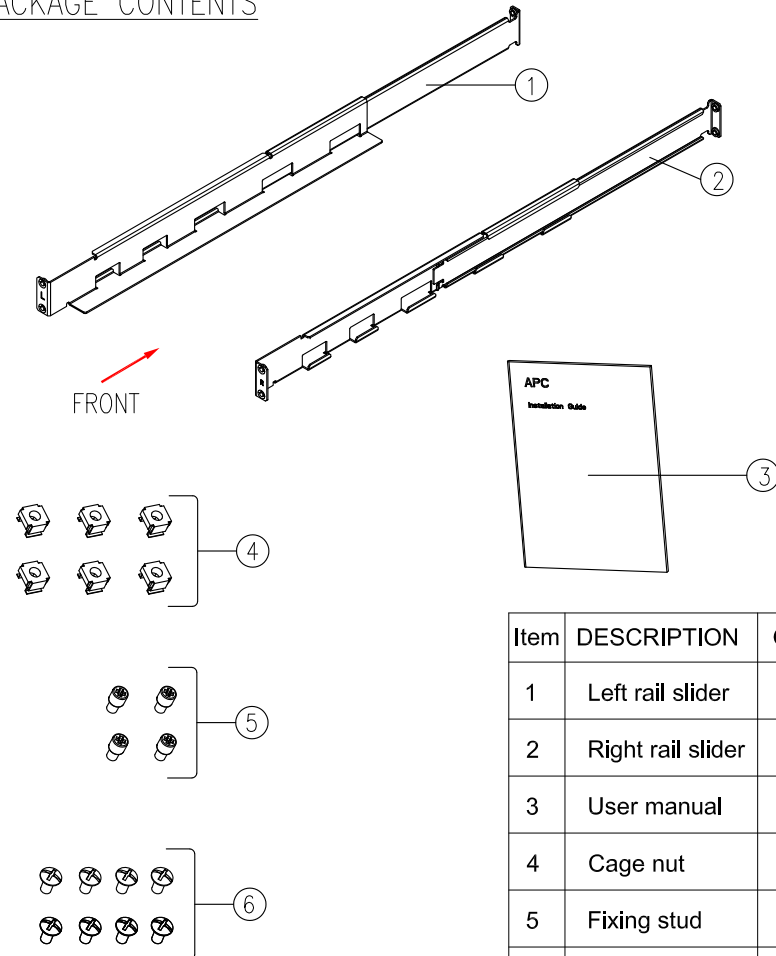

Item	DESCRIPTION	QUANTITY
1	Left rail slider	1
2	Right rail slider	1
3	User manual	1
4	Cage nut	6
5	Fixing stud	4
6	M6 screws	8

- NOTES:**
1. INSTALLATION SHALL COMPLY WITH ALL APPLICABLE NATIONAL, STATE AND LOCAL ELECTRICAL REGULATIONS.
  2. REFER TO PRODUCT DOCUMENTATION FOR ADDITIONAL DETAILS PRIOR TO INSTALLATION AND SITE PREPARATION WORK.
  3. ALL DIMENSIONS ARE IN MILLIMETERS [INCHES].
  4. NET WEIGHT OF THE UNIT IS 1.44KG [3.17 lb].

THIS DRAWING AND SPECIFICATIONS HEREIN ARE THE PROPERTY OF SCHNEIDER ELECTRIC AND SHALL NOT BE COPIED, REPRODUCED OR USED IN WHOLE OR IN PART, AS THE BASIS FOR THE MANUFACTURE OR SALE OF ITEMS WITHOUT WRITTEN PERMISSION FROM SCHNEIDER ELECTRIC. THIS DRAWING IS BASED UPON LATEST AVAILABLE INFORMATION AND IS SUBJECT TO CHANGE WITHOUT NOTICE.

**Schneider Electric**

**TITLE:**  
Easy UPS ON-LINE SRV/SRVS  
19" RAIL KIT, 700mm DEPTH  
GENERAL ARRANGEMENT

PROJECT: SUBMITTAL DRAWINGS

**DWG NO:** SRVRK1/SRVSRK1 **REV.** 0

**DRAWN BY:** RANJITHA **26-AUG-21**

**ENGINEER:** PRITHVIRAJ **31-AUG-21**

**APPROVED BY:** LIPARE **31-AUG-21**

**FIRST ANGLE PROJECTION**